



# INTERIOR/EXTERIOR

T&G, BEADBOARD, SHIPLAP & TRIM BOARDS



**KUIKEN BROTHERS**  
COMPANY INC. *Since 1912*  
RESIDENTIAL & COMMERCIAL BUILDING MATERIALS

30 YR WARRANTY ON PROTECTED BOARDS,

Warranty is based on proper installation

IDEA BOOKS by  WINDSORONE BUILD★AMERICA 

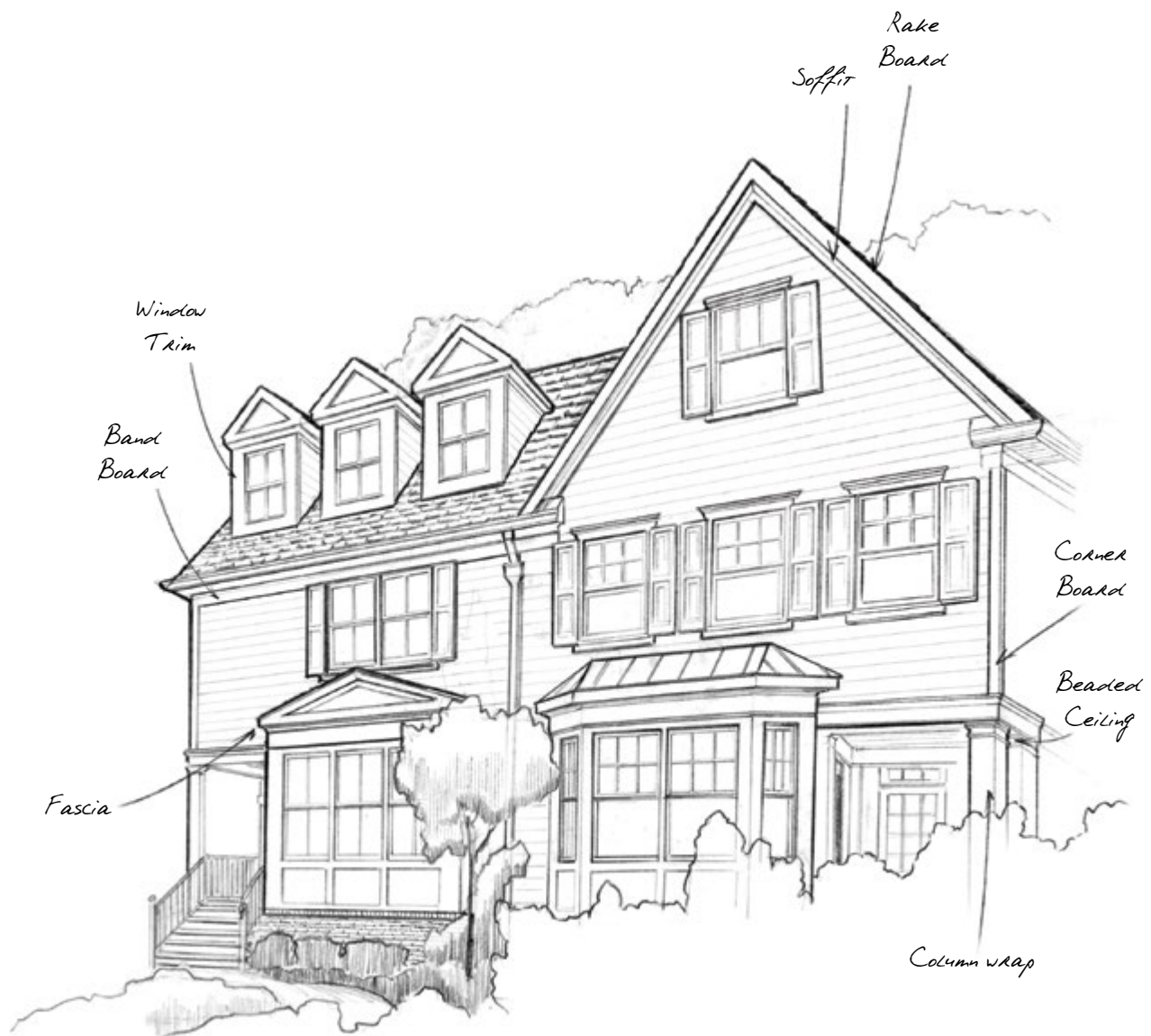

## ✓ RECOMMENDED FOR:

- ✓ DOOR TRIM
- ✓ WINDOW TRIM
- ✓ FASCIA
- ✓ CORNER BOARD
- ✓ SOFFIT
- ✓ BAND BOARD
- ✓ RAKE
- ✓ COLUMN WRAPS

## ✗ DO NOT USE FOR:

- ✗ SIDING
- ✗ DECKING
- ✗ PLANTERS
- ✗ HAND RAILS
- ✗ PERGOLAS
- ✗ FENCES
- ✗ TRELLISES
- ✗ STAIRS (exterior)

SEE FULL INSTALLATION INSTRUCTIONS at [WindsorONE.com/install](https://www.WindsorONE.com/install) or call 888.229.7900. Warranty based on proper installation.





CREDITS 1.First Lamp Architecture & RW Anderson Homes in WA 2-5, 7, 9.WindsorONE Archive 6.Art Guerrero in CA 8.Dave Bell in CA

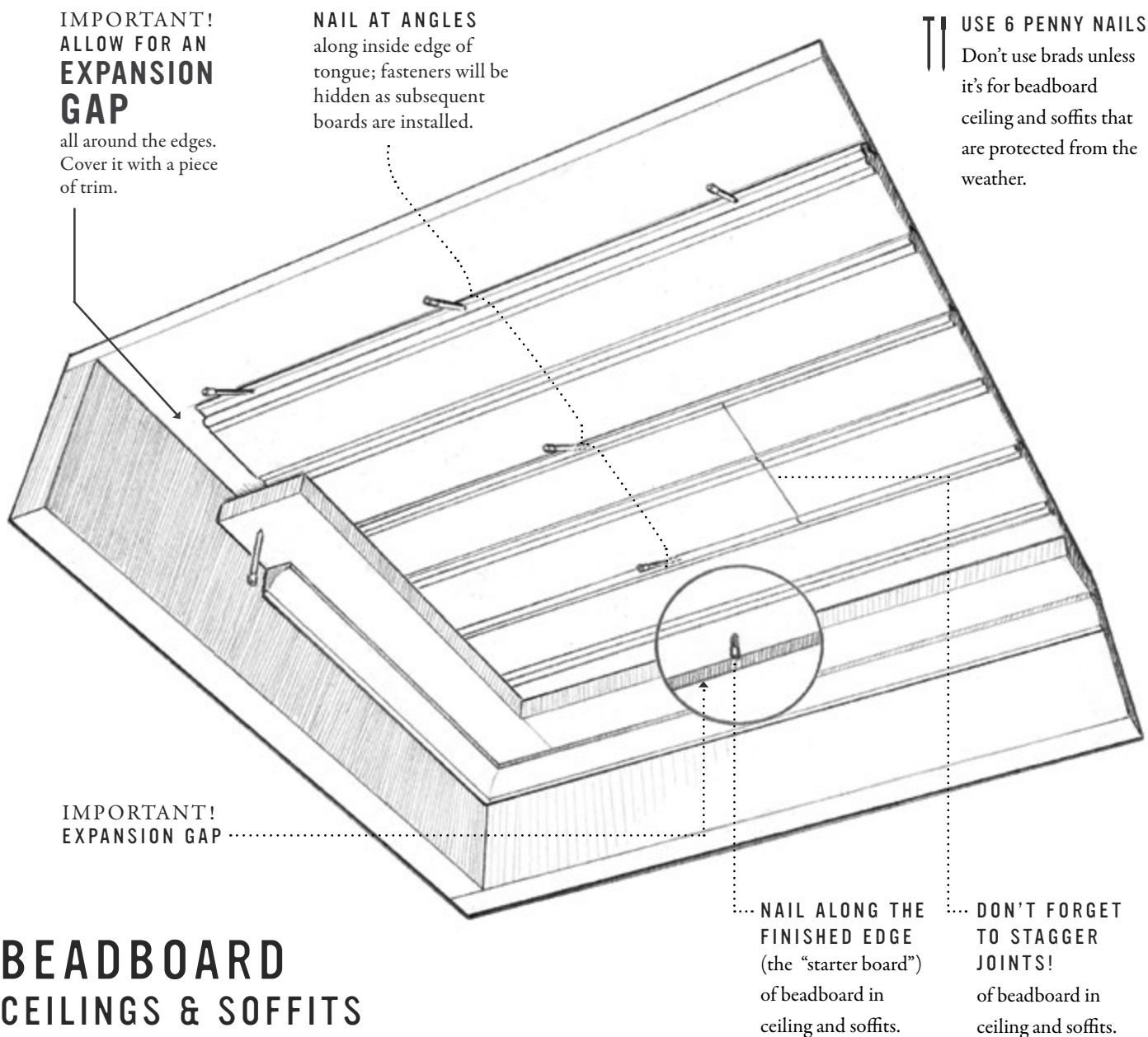

## BEADBOARD CEILINGS & SOFFITS

### Always isolate beadboard

from framing members and soffit/attic spaces. Moisture, humidity and any water intrusion will alter the moisture content of beadboard and could radically affect the installation.

### Provide adequate ventilation

for all beadboard installations, and use best building practices to provide for normal swelling and shrinkage. Further protect against adverse swelling and shrinkage by breaking up long spans with beams or other decorative trim.

### Other tips:

**CHECK MOISTURE CONTENT** For the exterior, never install beadboard with a moisture content higher than 18%. (For interiors, acclimate the beadboard until it reaches the in service moisture content of about 8%).

**CHAMFER THE ENDS** using a 45 chamfer bit on a router to accent the joints and allow the boards to move without affecting the overall appearance.

**HOUSEWRAP** Prior to installing beadboards, soffits must be sheathed and wrapped with house wrap.

**VENTILATION** When wrapping soffits and exterior ceilings, take care not to block attic ventilation mechanisms.

**NO CAULK OR GLUE** Never caulk or glue beadboard tongue-and-groove joints.

SEE FULL INSTALLATION INSTRUCTIONS, *Warranty based on proper installation.* **CREDITS** 1. Dave Bell in CA 2. Robert Gamen in CA 3. Holland Construction in CA 4. Joe Denman Carpentry for Baker Barn Restoration in PA 5. Perry & Papenhausen Inc. in CA 6. Gallagher Construction



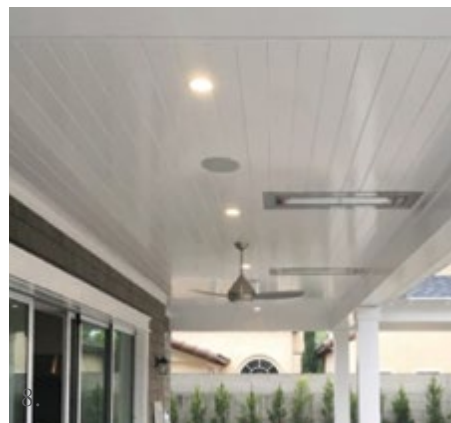

7. Woodsmith Construction LLC in NJ 8. Lyons Construction in CA 9. Seven Development & Woods Architecture LLC in AZ

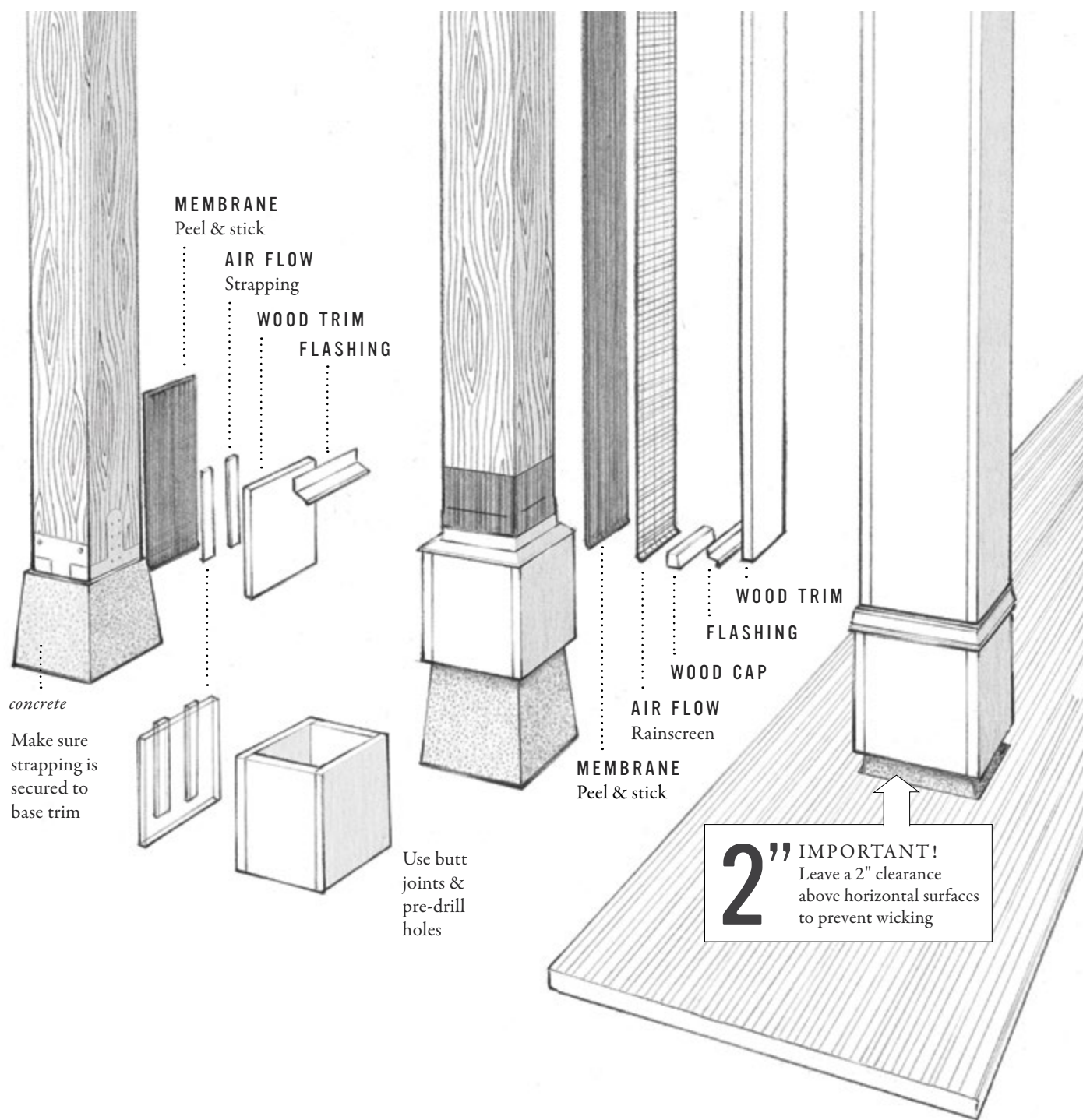

# COLUMN WRAPS

## Incorporate an air cavity.

Columns wrapped in WindsorONE Trim Boards must be constructed to incorporate an air cavity between the WindsorONE Trim Boards and the underlying structure. Furring strips or 3 dimensional drainage mats ensure that the backside of the trimboards are drained and ventilated. The diagram illustrates proper column wrap construction.

**CREDITS** 1, 6, 9. W1 Archive 2. Art Guerrero in CA 3, 8. Vanberg Construction in CA 4. Perry & Papenhausen Inc. in CA 5. Pagenkopp Construction in CA 7. Concept Construction in WA

SEE FULL INSTALLATION INSTRUCTIONS at [WindsorONE.com/install](http://WindsorONE.com/install) or call 888.229.7900. Warranty based on proper installation.



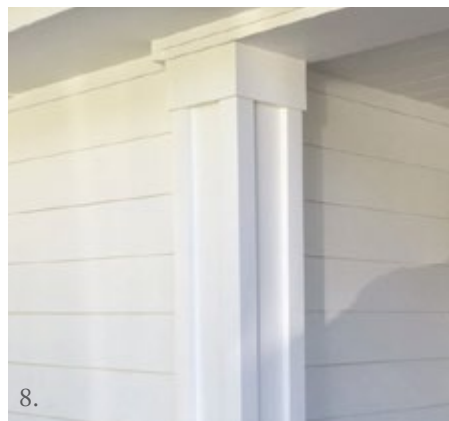
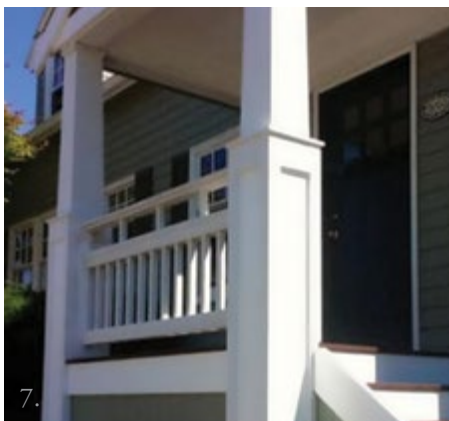
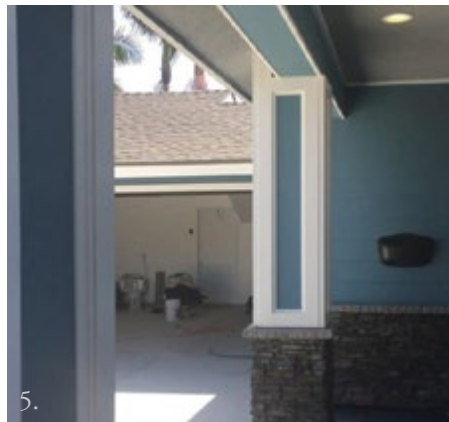



## INSTALLATION SIMPLIFIED\*

*These are just some tips, see the full installation instructions*



1.

### **2"** INSTALL 2" ABOVE PORCHES, ROOFS, ETC:

2" breaks are crucial on the porches, roofs and all flat surfaces (patios, decks, etc).



### STORAGE - KEEP IT COVERED & ELEVATED:

Store on stringers and out of the weather. See installation instructions if storing the material outdoors.



6"

### **6"** INSTALL 6" ABOVE GRADE:

Trim should be installed at least 6" from ground.



### MOISTURE CONTENT:

Exterior in-use moisture content is approx. 14%. (For interior, make sure you properly acclimate material and do not install when moisture content is over 8%.)



### **1/4"** INSTALL 1/4" ABOVE FLASHING:

Flashing is imperative, but maintain a 1/4" gap for a capillary break.



### PRIME ALL CUTS!:

Prevents moisture absorption & helps ensure a long lasting project. This includes cuts that can't be seen or may not be directly exposed to weather.

\*SEE FULL INSTALLATION INSTRUCTIONS at [WindsorONE.com/install](http://WindsorONE.com/install) or call 888.229.7900. Warranty based on proper installation.





CREDITS 1. Dave Bell in CA 2-4, 6. WindsorONE Archive 5. Schielein Builders in CA 7. Art Guerrero in CA

SCALE

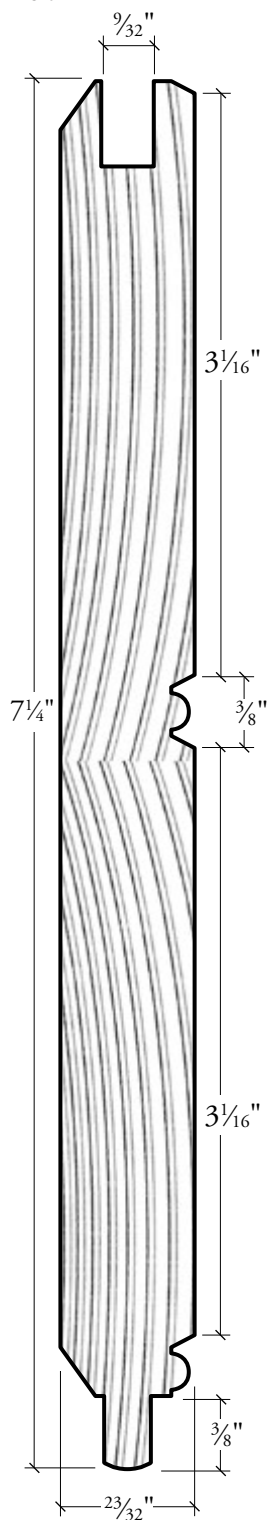

**KB906**

standard T&G  
beadboard 16'

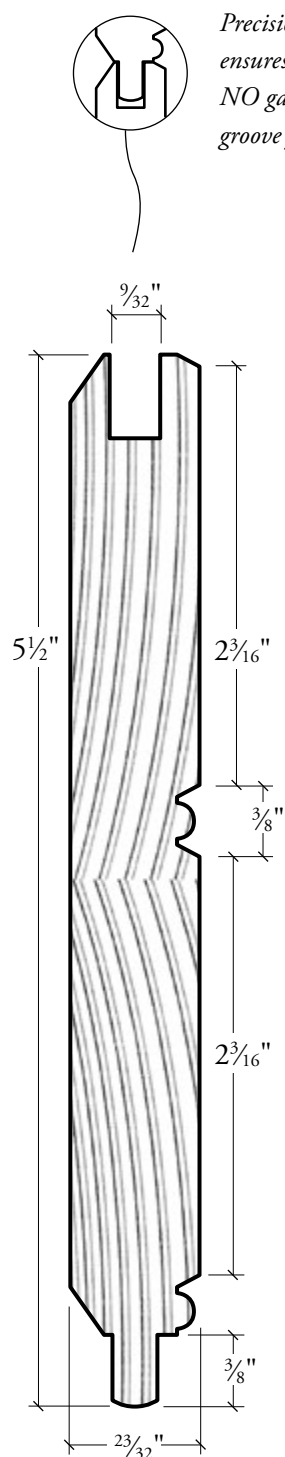

**KB904**

standard T&G  
beadboard 16'

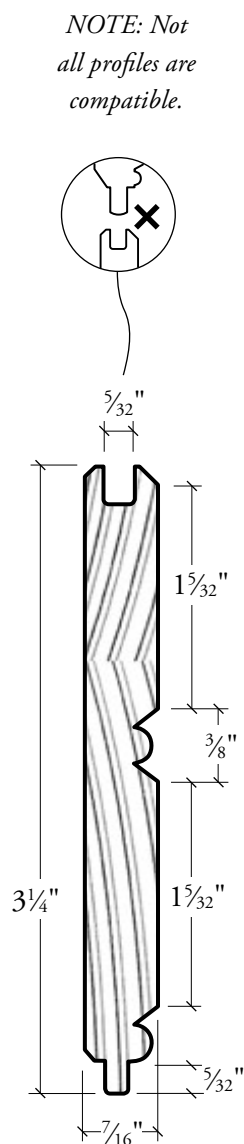

**KB908**

standard T&G  
beadboard 16'

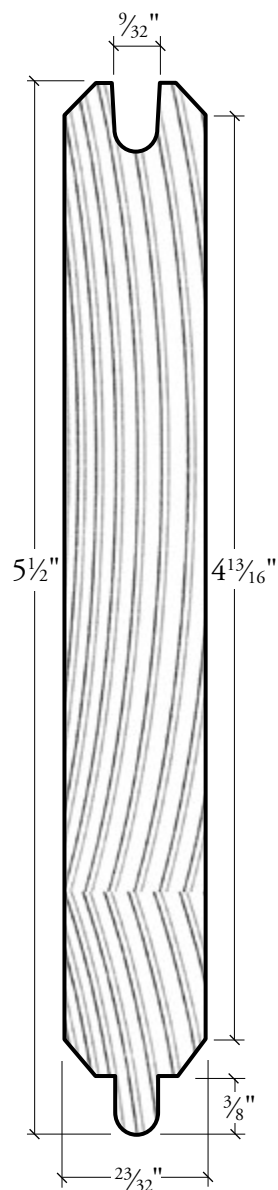

**KB900**

T&G  
board 16'

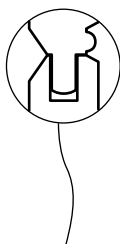

*Precision manufacturing  
ensures a perfect fit, with  
NO gaps, on tongue &  
groove joints.*

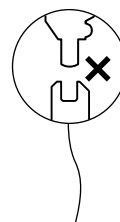

*NOTE: Not  
all profiles are  
compatible.*



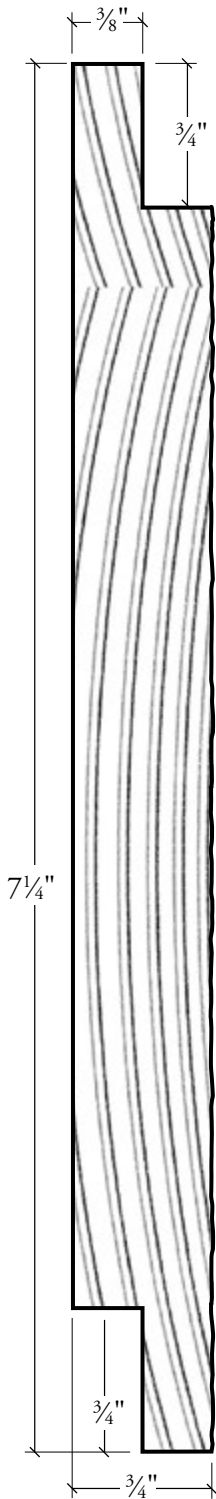

### KB915

reversible  
shiplap 16'

*Shiplap profiles  
are Reversible, smooth  
on front with a  
ROUGH SAWN BACK*

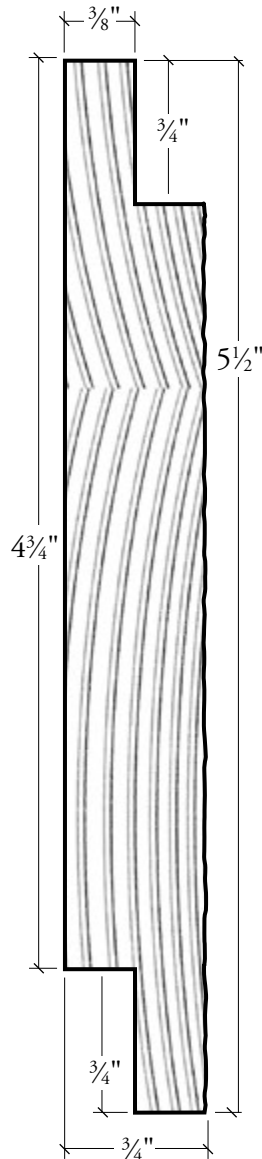

### KB914

reversible  
shiplap 16'

**30** LIMITED\* WARRANTY  
YEAR INTERIOR/EXTERIOR USE

nominal sizes	net sizes	profiles in 16' lengths
1 x 2	3/4" x 1 1/2"	
1 x 3	3/4" x 2 1/2"	
1 x 4	3/4" x 3 1/2"	
1 x 5	3/4" x 4 1/2"	
1 x 6	3/4" x 5 1/2"	
1 x 8	3/4" x 7 1/4"	
1 x 10	3/4" x 9 1/4"	
1 x 12	3/4" x 11 1/4"	
5/4 x 3	1 1/16" x 2 1/2"	
5/4 x 4	1 1/16" x 3 1/2"	
5/4 x 5	1 1/16" x 4 1/2"	
5/4 x 6	1 1/16" x 5 1/2"	
5/4 x 8	1 1/16" x 7 1/4"	
5/4 x 10	1 1/16" x 9 1/4"	
5/4 x 12	1 1/16" x 11 1/4"	

### S4SSE

1x & 5/4x 16'



**WARRANTY\***  
INTERIOR/EXTERIOR USE

## PROTECTED TONGUE & GROOVE

	KB908	7/16" x 3 1/4"
	KB904	23/32" x 5 1/2"
	KB906	23/32" x 7 1/4"
	KB900	23/32" x 5 1/2"
	230	1 1/16" x 7 1/2"
	plantation	3/4" x 5 1/2"

## PROTECTED SHIPLAP\*\*

	KB914	3/4" x 5 1/2"
	KB915	3/4" x 7 1/4"

\*\*Shiplap is choose your own gap, butt joint up to 1/2" gap, smooth or rough side out

## PROTECTED S4SSE PFJP TRIM

*smooth surface four sides*

nominal sizes | 16'

	1x2	•
	1x3	•
	1x4	•
	1x5	•
	1x6	•
	1x8	•
	1x10	•
	1x12	•
	5/4 x 3	•
	5/4 x 4	•
	5/4 x 5	•
	5/4 x 6	•
	5/4 x 8	•
	5/4 x 10	•
	5/4 x 12	•



## RESIDENTIAL & MILLWORK SHOWROOMS:

**FAIR LAWN, NJ: 201.796.2082**

6-02 Fair Lawn Ave., Fair Lawn, NJ

**EMERSON, NJ: 201.262.6666**

246 Kinderkamack Rd., Emerson, NJ

**MIDLAND PARK, NJ: 201.652.1000**

145 Lake Ave., Midland Park, NJ

**NEWARK, NJ: 973.638.7200**

500 Doremus Ave., Newark, NJ

**ROSELAND, NJ: 973.226.5700**

14 Eisenhower Parkway, Roseland, NJ

**SUCCASUNNA, NJ: 973.968.7700**

33 Route 10 East, Succasunna, NJ

**WANTAGE, NJ: 973.875.5106**

175 Route 23, Wantage, NJ

**WARWICK, NY: 845.986.2255**

33 South Street, Warwick, NY



10 THINGS ABOUT

**WINDSORONE**  
PROTECTED BOARDS

**18+**  
YEARS

**1 ZERO CLAIMS AGAINST ROT, INSECTS & MOLD**  
Since its' launch, Protected Boards have been used on the exterior of homes with 0 claims against rot, insects & mold.

**30**  
YEAR

**2 BACKED BY A 30-YEAR LIMITED\* WARRANTY**  
The "limitation" is you have to install it correctly (for one example see #8 again).



**3 PROTECTED TO THE CORE; FULL PENETRATION**  
Because unlike the other guys, we're assuming you'll actually want to cut the material at some point.



**4 PROTECTED AGAINST ROT, INSECTS & MOLD**  
Does *not* protect against your mother-in-law, hangovers, airport security, etc.



**5 DURABLE FOR EXTERIOR & SAFE FOR INTERIOR**  
Gold Indoor Air Quality Rating, low VOC's and California Hippie Approved.



**6 WEATHER RESISTANT SYSTEM (WRS™)**  
Water is for drinking, not trim boards.



**7 NO KNOTS; YOUR BOARDS ARE ALWAYS CLEAR**  
Imagine that, you can actually use every foot you pay for.



**8 PROTECTION NOT DIMINISHED**  
By shaping, planing, sanding, fastening or molding (actual use does not void the warranty).



**9 THE CUT SURFACES ONLY NEED PRIMING**  
No need to also apply special protection (we took care of that for you).



**10 BUILD AMERICA: MANUFACTURED IN THE U.S.A.**  
Because everything else you bought was made in China.

## INSTALLATION REMINDERS\*



### PRIME ALL CUTS!

**MOISTURE CONTROL<sup>1</sup>:** Acclimate to the environment. For interior trim, store inside the structure until the products reach approx 8% moisture content. For exterior trim, store in locations such as a garage that is not heated & is well ventilated until about 14% moisture content. Do not install exterior trim boards with a moisture content over 18%. <sup>1</sup>see [www.windsorone.com/moisturecontrol](http://www.windsorone.com/moisturecontrol)



**KEEP MATERIAL COVERED:** Store on stringers and out of the weather.



**INSTALL 6" ABOVE GRADE:** Trim should be installed always at least 6" from ground.



**INSTALL 2" ABOVE ROOF:** 2" breaks are crucial on the roof and flat surfaces (porches, decks, etc).

**1/4" FROM FLASHING:** Flashing is imperative; and always maintain a 1/4" gap for a capillary break.



**\*SEE FULL INSTALLATION INSTRUCTIONS.** WindsorONE should be stored, installed, handled & maintained correctly for the best performance. For complete installation guidelines & the WindsorONE Protected warranty, visit [WindsorONE.com/install](http://WindsorONE.com/install) or call 888.229.7900.

WindsorONE Protected is manufactured by Windsor Surry Company, an affiliate of WindsorONE | Manufactured in the U.S.A. WindsorONE.com ©2025 WindsorONE